

# JAW CRUSHER CJ SERIES

## CJ211

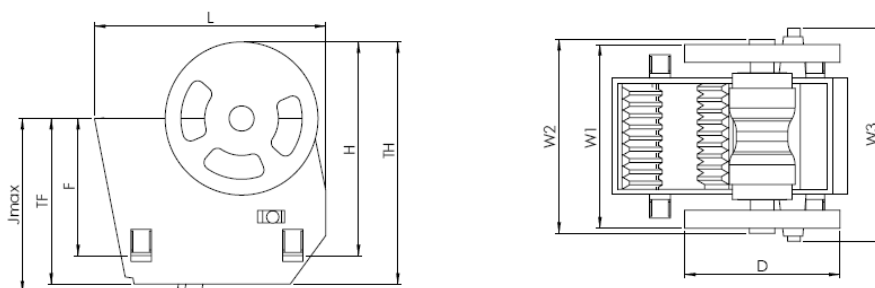

### DIMENSIONS (mm)

Jmax,	TF	F	L	H	TH	W1	W2	W3	D
1 585	N.A.	1 120	2 386	1 735	N.A.	2 054	2 082	2 442	1 230

### WEIGHTS (kg)

Flywheel	Toggle Plate	Toggle Seat	Swing Jaw Complete	Frame Complete	Total Weight (approx.)
850	160	25	6 000	8 300	14 300

### PERFORMANCE

Feed Opening (mm)	1 100 x 700									
Max feed size (mm)*	630									
Max motor power (kW)	90									
CSS (mm)	60	70	80	90	100	125	150	170	200	
Nominal Cap MTPH	110-160	120-180	135-205	150-230	160-250	195-310	230-370	265-430	300-490	
Standard Jaw Plates	Corrugated (C) / Sharp Tooth (ST)									

\* Apply for regularly shaped material. Occasional larger lumps can be accepted, but if material is irregularly shaped, difficulties may be also experienced with smaller lumps.

The left figures refer to fines removed from feed and the right refers to fines included in the feed.